

9'4" x 3'4"

Nursery

Connects To growing unit

8' sliding door

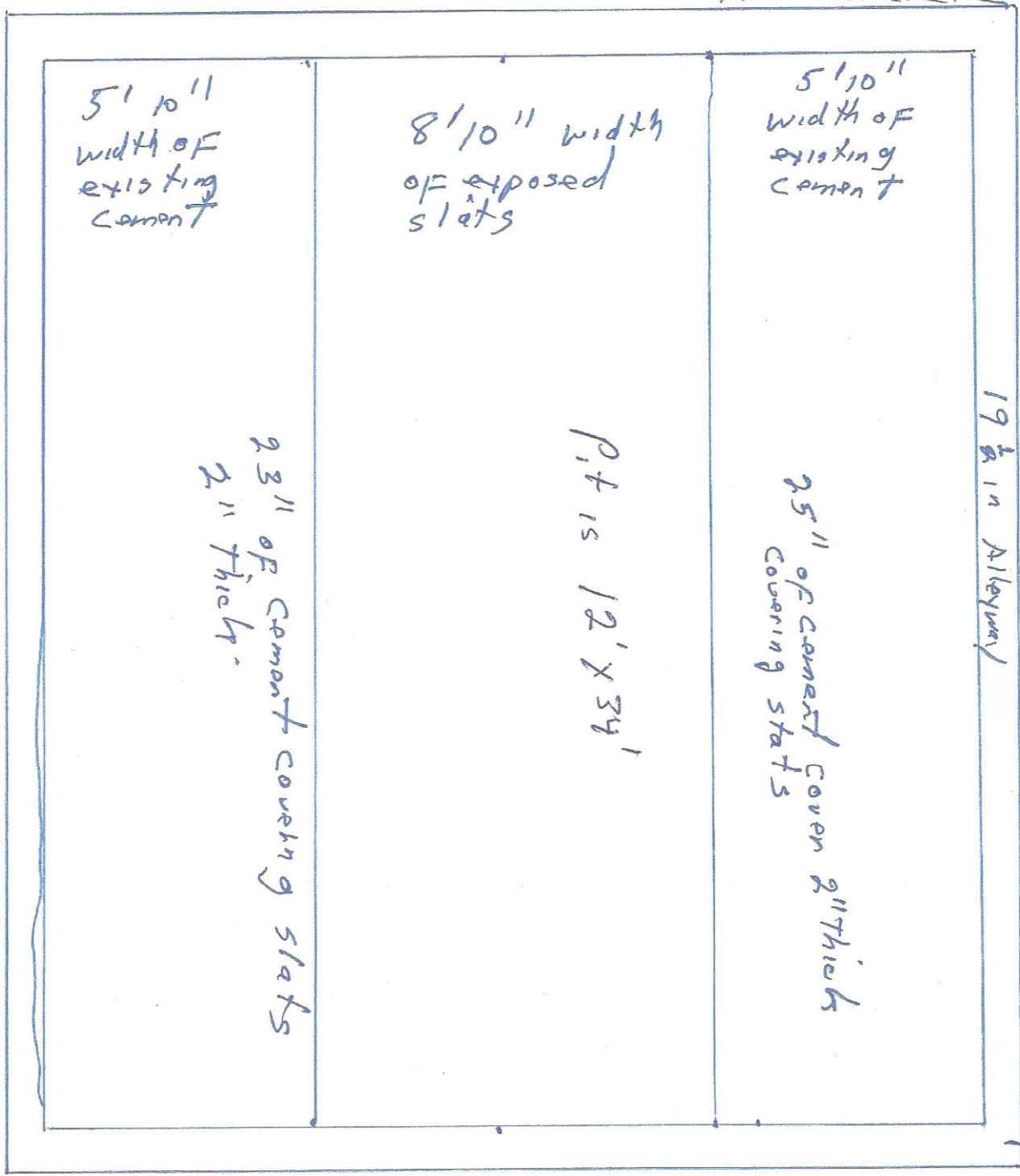

5'10" width of existing cement

8'10" width of exposed slats

5'10" width of existing cement

23" of cement covering slats 2" thick

Pit is 12' x 34"

25" of cement cover 2" thick covering slats

19 1/2" in Alleyway

entry way  
walk door

94430  
Growing  
Unit

West

Pit  
Access hole  
from

10' 3" Existing Slats

11' 6" width of existing Cement  
walk door  
sliding door

Pit 15'  
12' x 30'

Pit under this area  
Has gang slides 5' x 12' - Slats are 5' wide  
Cement 2" Thick cover slats for 22' 2" on  
south end of slats  
Slats sit on pit wall on the south  
Slats sit on pit wall on the north wall  
There is 2 3/4 in lip

Cement slopes to the north toward  
Pit

19 ft in Alleyway

sliding door

3 1/2  
Thick

Foot

North

24' x 30' Room in 24' x 64' building - Rough sketch

6" wall

13'

9' 10"

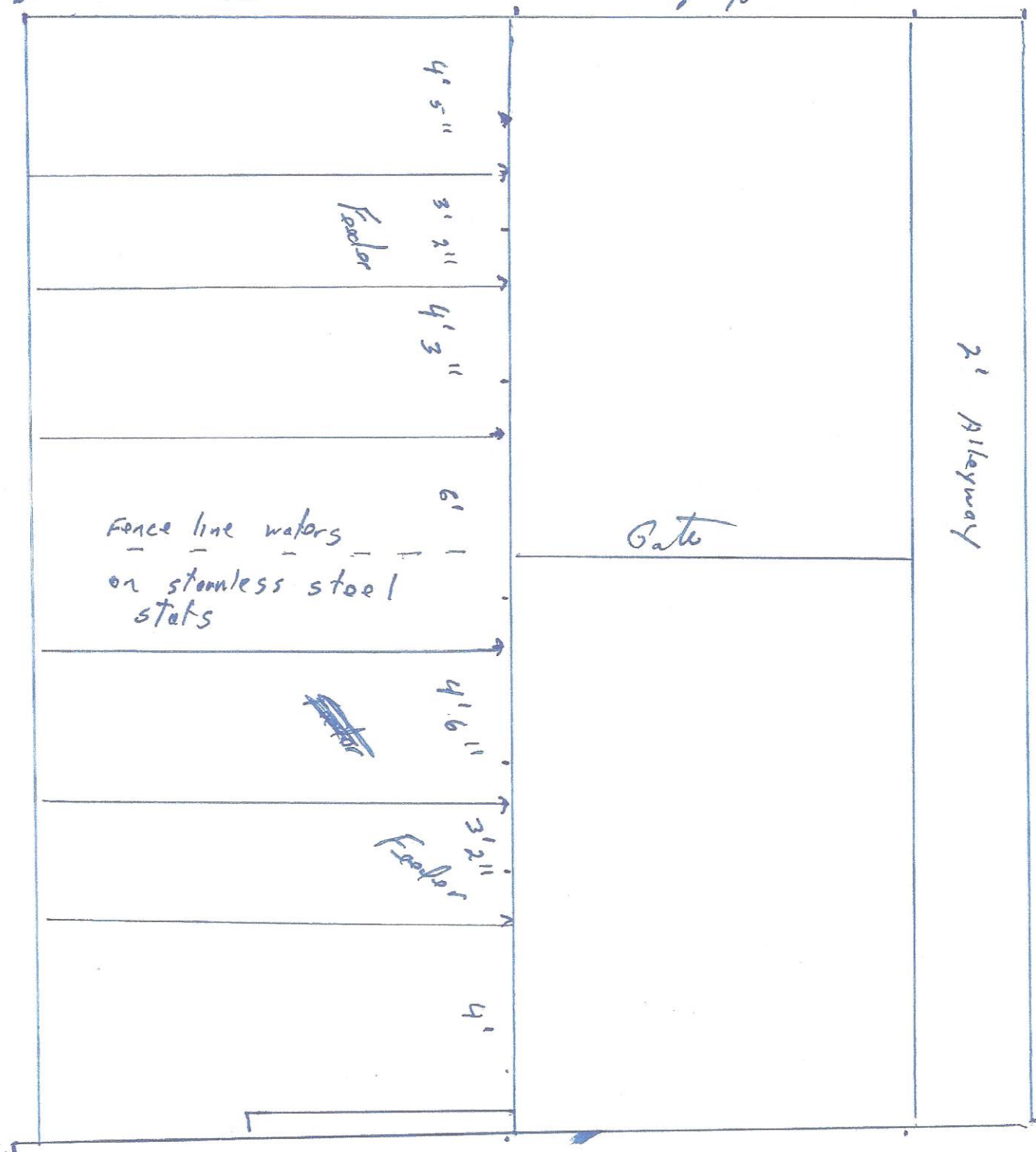

2' Alleyway

Gate

Fence line waters  
on stainless steel  
studs

Feeder

Feeder

4' 5"

3' 2"

4' 3"

6'

4' 6"

3' 2"

4'