

Pearling Machine Plans

# Dust Collector Hookup Assembly

Nigel Tudor  
Weatherbury Farm



*This material is based upon work supported by the National Institute of Food and Agriculture, U.S. Department of Agriculture, through the Northeast Sustainable Agriculture Research and Education program under subaward number FNE19-945. Any opinions, findings, conclusions, or recommendations expressed in this publication are those of the author(s) and do not necessarily reflect the view of the U.S. Department of Agriculture.*

Project details found at [https://projects.sare.org/sare\\_project/fne19-945/](https://projects.sare.org/sare_project/fne19-945/)

Material: 4" Exhaust Tube

Number Required: 1

Process Notes:

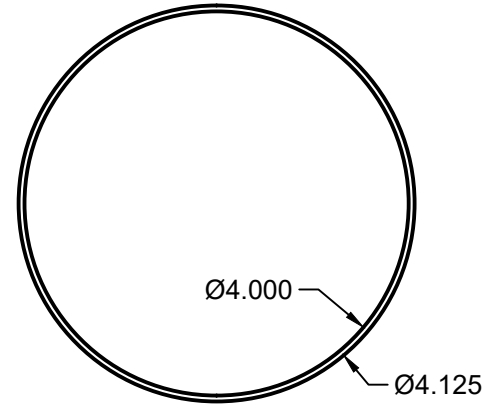
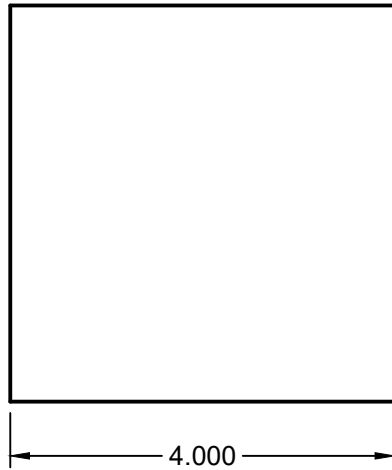

Revision Record

Date

Tolerances

Date:

9/13/2022

Part Number:

DC 2

(except as noted)  
Decimals:  
+/- .005 except where noted  
Fractional:  
+/-  $\frac{1}{32}$   
Angular:  
+/- 1°

Scale:

1:2

Title:

Pearling Machine

Drawn By:

NIT

Project Name:

Pearling Machine



Material: 16ga Mild Steel

Number Required: 1

Process Notes:

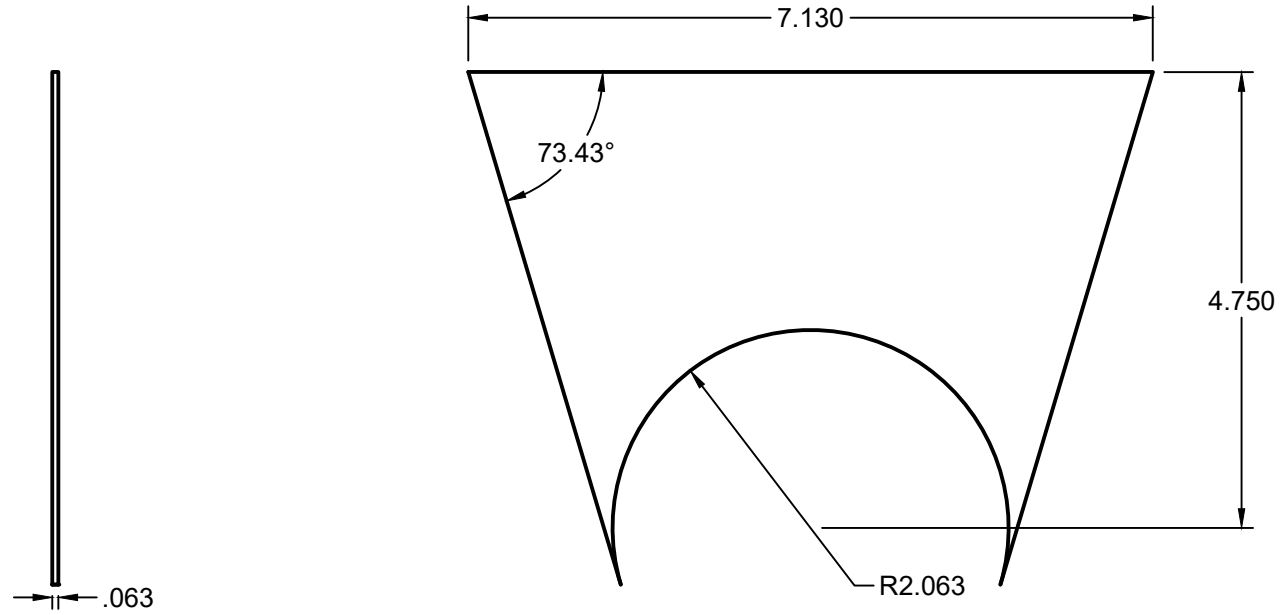

Revision Record	Date	Tolerances <small>(except as noted)</small> Decimals: +/- .005 except where noted Fractional: +/- $\frac{1}{32}$ Angular: +/- 1°	Date: 9/13/2022	Part Number: DC 6
			Scale: 1:2	Title: End Cap DC4
			Drawn By: NIT	Project Name: Pearling Machine

Material: 4" Exhaust Tube

Number Required: 1

Process Notes:

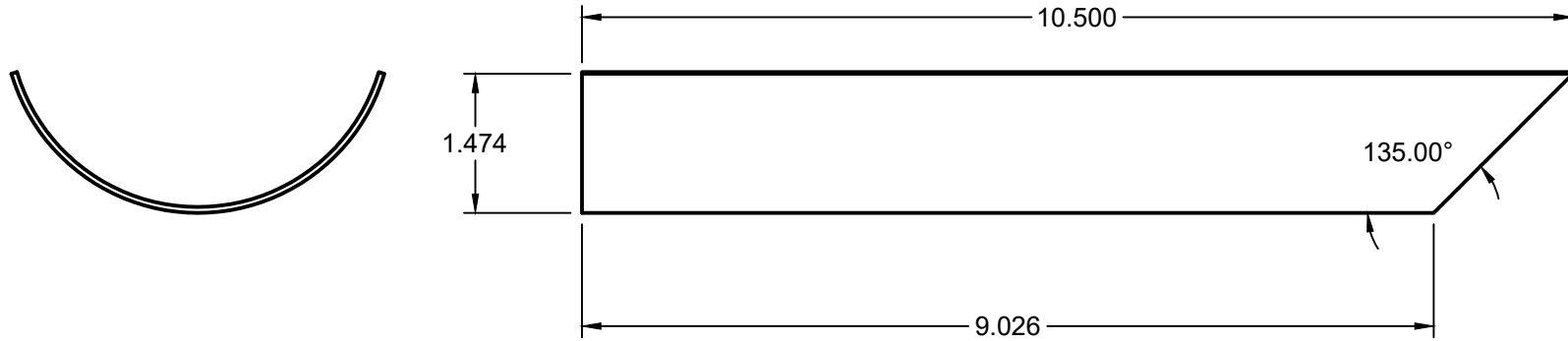

Revision Record	Date	Tolerances	Date:	Part Number:
		(except as noted) Decimals: +/- .005 except where noted Fractional: +/- $\frac{1}{16}$ Angular: +/- 1°	9/13/2022	DC 3
			Scale: 1:4	Title: Trough Bottom
			Drawn By: NIT	Project Name: Pearling Machine

Material: 16ga Mild Steel

Number Required: 1

Process Notes:

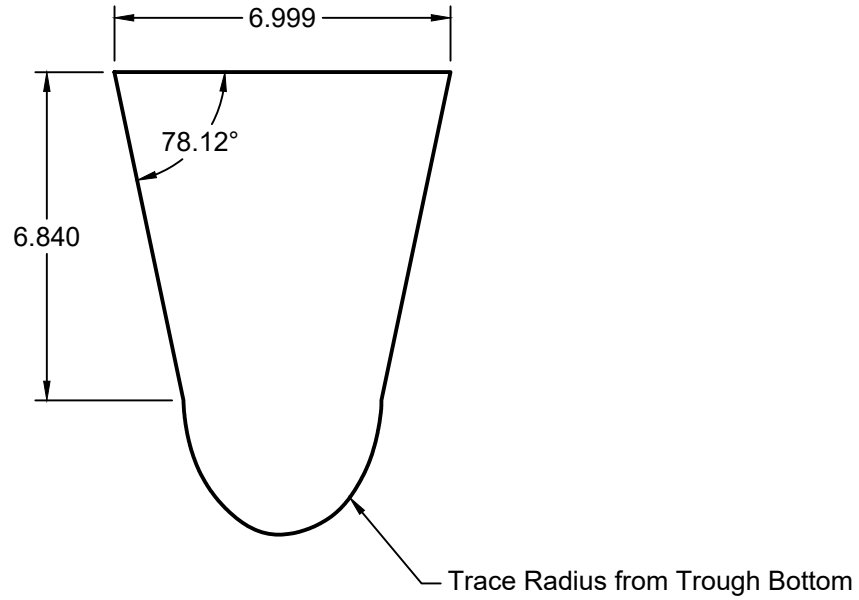
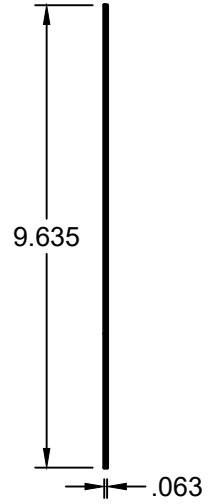

Revision Record

Date

Tolerances

Date:

9/13/2022

Part Number:

DC 5

(except as noted)  
Decimals:  
+/- .005 except where noted  
Fractional:  
+/-  $\frac{1}{32}$   
Angular:  
+/- 1°

Scale:

1:4

Title:

Trough End DC5

Drawn By:

NIT

Project Name:

Pearling Machine

Material: 16ga Mild Steel

Number Required: 2

Process Notes:

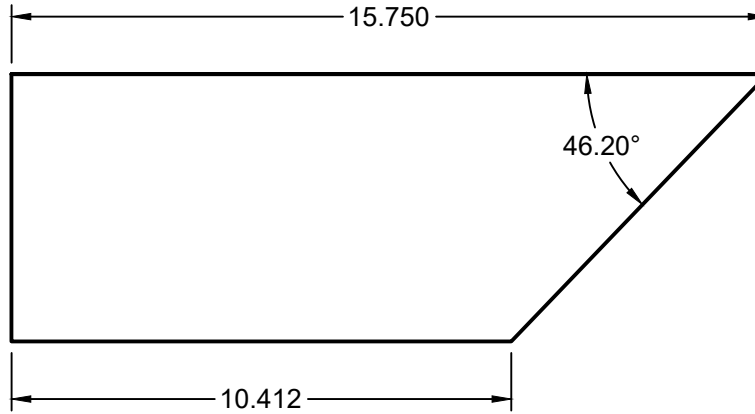
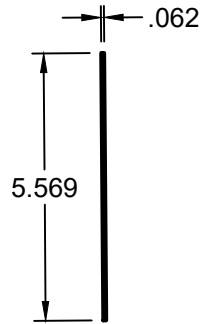

Revision Record

Date

Tolerances

Date:

9/13/2022

Part Number:

DC 4

(except as noted)  
Decimals:  
+/- .005 except where noted  
Fractional:  
+/-  $\frac{1}{32}$   
Angular:  
+/- 1°

Scale:

1:4

Title:

Trough Side DC4

Drawn By:

NIT

Project Name:

Pearling Machine