

HOT BOX COMPOSTING DIAGRAM

- 5 PLANTS ENJOY ENVIRONMENT RICH IN CO_2 , NO_3 , H_2O , AND HEAT DIRECTLY IN THEIR BED.
- 4 NH_3 IS CONVERTED TO USABLE NO_3 IN THE WOODCHIP BED, AS THE REST OF THE EXHAUST IS FED INTO THE GROW BED.
- 3 CO_2 , NH_3 , H_2O , AND HEAT ARE GIVEN OFF AND TRAVEL UP THE 1" PVC EXHAUST PIPES.
- 2 H_2O , C , AND N COMBINE WITH O_2 AS THE COMPOST BREAKS DOWN.
- 1 O_2 ENTERS THROUGH FAN INTO PERFORATED 4" PVC PIPE, BURIED IN WOODCHIP BED.

TYPE I: "OVER ENGINEERED"

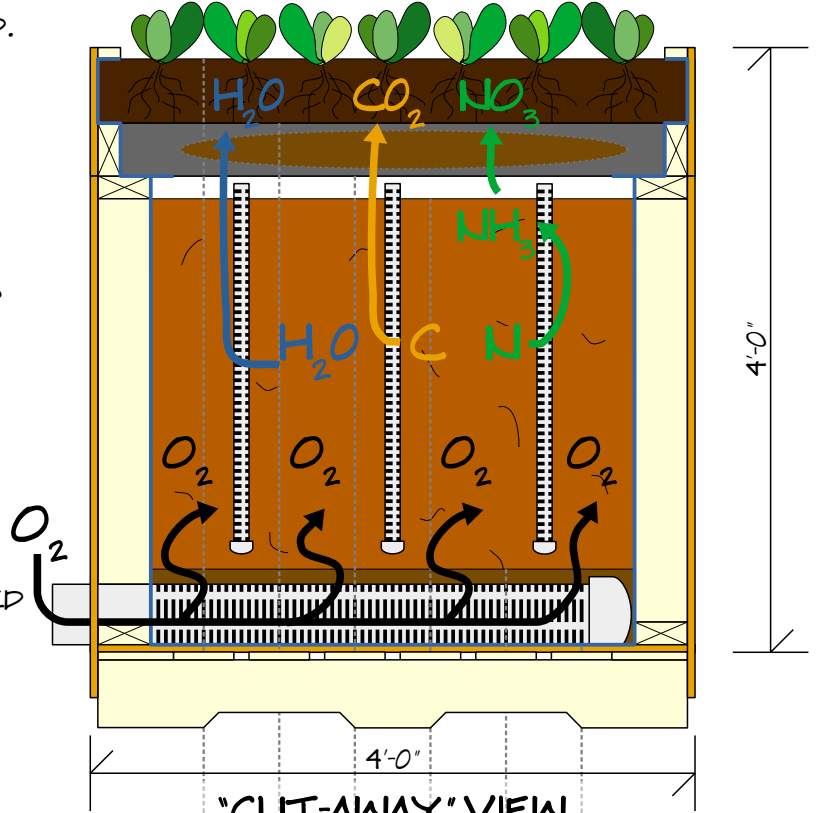

TYPE II: "SIMPLE"

- PLYWOOD SIDES
- GROW BOX WITH BOTTOM SCREEN ON SUPPORTS.

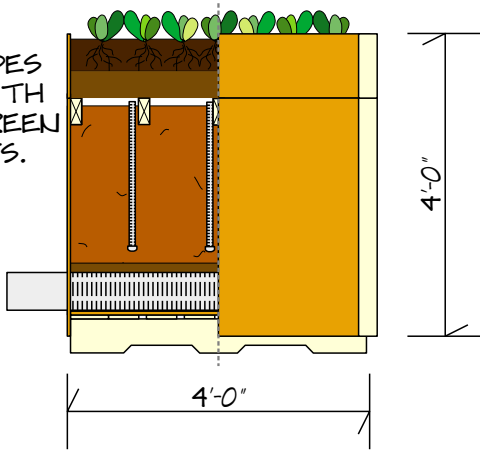

- LID AND SIDE OF BOTH TYPES OPEN FOR EASIER FILLING AND EMPTYING

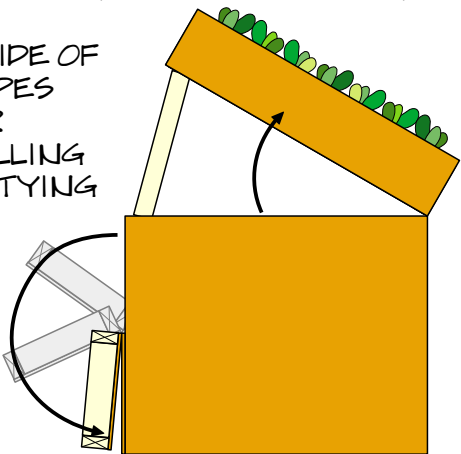

"CUT-AWAY" VIEW
(FROM TOP [LEFT] TO BOTTOM [RIGHT])

